

Adding the ARC chips to the PGI-9

IDEALLY YOU WILL CARRY THIS OUT PRIOR TO REFILLING

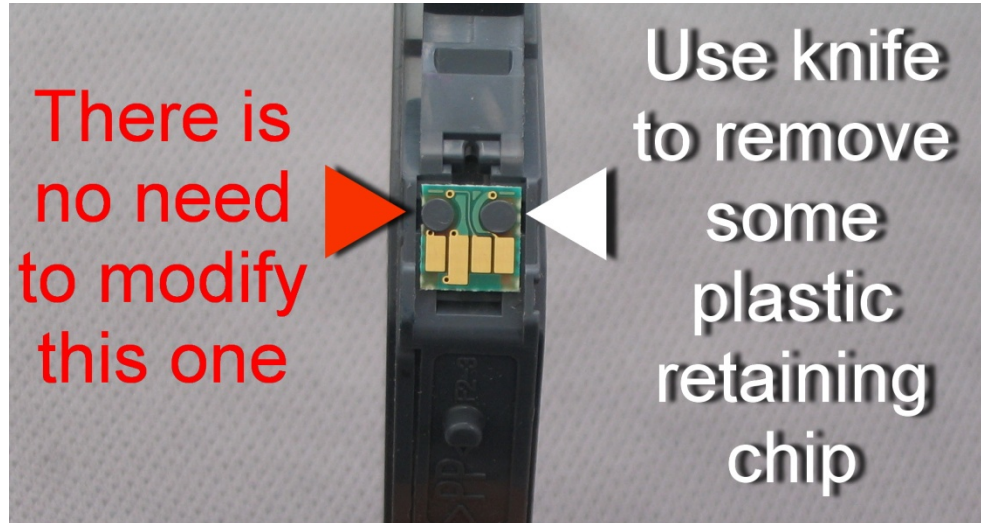

- You will remove some of the material on the right hand nub that was melted flat to retain the chip to the tank body. Only remove the least amount of material to allow right side of the chip to be lifted loose.
- There is no need to tamper with the left side nub.
- When the right side is loose enough to be lifted clear of the nub, you will slide the chip to the right to remove the chip.
- Installing the ARC chip is the opposite. Slide the chip under the left side nub and then drop the right side down over the nub. Normally, the chip will remain nicely placed and will not drop out. If the chip is loose you can place a tiny drop of adhesive over the right nub ONLY to help retain it.

OPERATION:

The ARC chip will reset itself to FULL each time the printer is cycled off and on. Thus you will need to keep the printer on at all times if the ARC chip is to be accurate in keeping track of the ink level. Anytime the printer is power cycled or power is lost and restored, you should check the physical ink level of the tanks using the ARC chips prior to printing or refill them as the ARC chips will indicate ink is full even when they physically might not be. **Printing with physically empty ink tanks can potentially damage the printhead permanently.**